



Getting Started

Before installation, check the product for any shipping damages. If you find damages, do not install and contact your dealer or ICO.

Any wall to which the vanity will be installed (with/without legs) must be of suitable construction to support the product's weight.

Required Tools and Materials

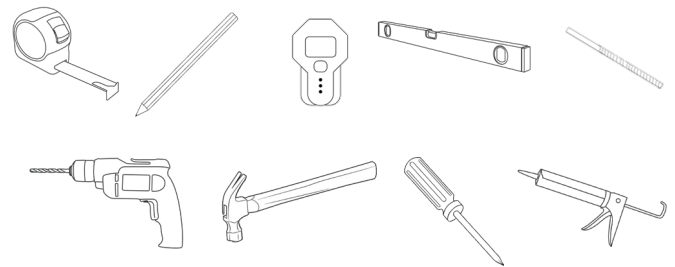

Vanity Installation

- 1 Unpack your vanity and set it on the floor – ensure you lay out floor protection – cardboard, towel etc.
- 2 Remove the drawers from the vanity – pull drawers all the way out, press levers underneath, then lift drawer upwards and out.

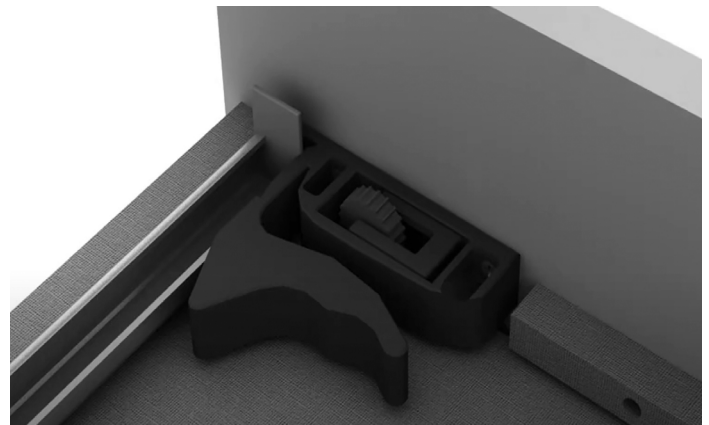

- 3 WITH LEG SET ONLY – turn vanity upside down, and use drill to attach legs to the bottom of the vanity using the provided screws.

(Modern Leg Set) - Ensure that these are fixed to the bottom panel of the vanity. Do not screw into the side panel of the vanity as it may cause the wood to split.



- 4 Determine the location of your vanity – we strongly recommend mounting to studs or wood backing. A horizontal stud or backing works best to ensure both brackets are firmly secured.

Mark the location of the vanity brackets on the wall – ensure enough space for legs underneath is allowed if you are using the leg set.



- 5 Predrill brackets and install provided drywall anchors – we suggest an 8mm - 1/8 inch bit (not necessary if mounting into studs).



- 6 Attach brackets to wall using provided screws.

Hang the vanity on the brackets.

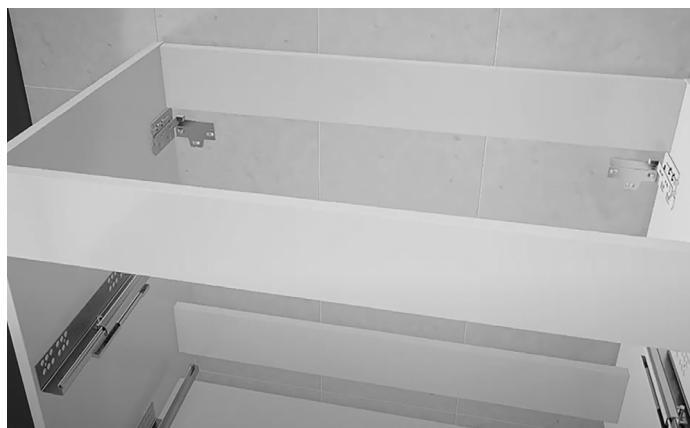

- 7 Use the adjustment feature on the hangers to level your vanity.

The top screw adjusts the vanity up and down, and the bottom screw adjusts the vanity front to back.

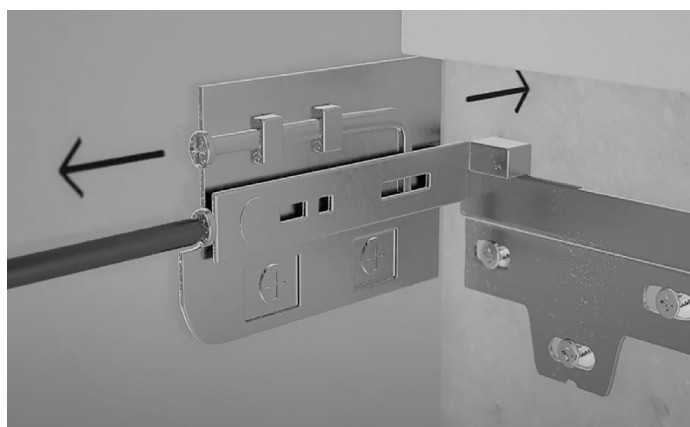
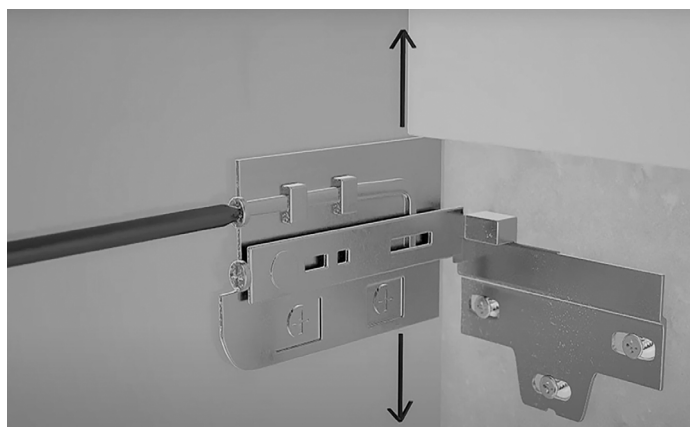

- 8 Silicone the top edges of the vanity, and place sink/top – allow 24 hours for silicone to dry and cure.



- 9 There are holes predrilled halfway through from the back of the drawer front for your vanity handles.

If you chose a Calma handle that matches this distance, continue drilling these holes from the back to the front. DO NOT push hard on your drill as it will cause damage to the drawer front.

If you chose a handle from a different brand, please ignore these holes and drill custom ones according to the size of your handle.

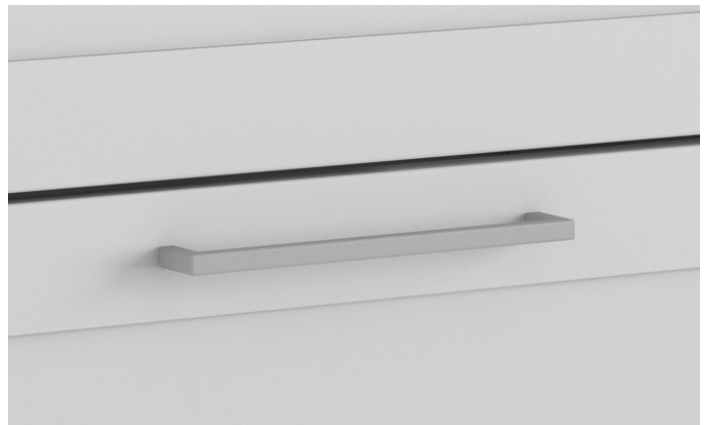

- 10 Add drawers back in. You will hear a click as the drawer sits into the correct position. Install handles.

Thank you for choosing Calma!
Exhibit your Style

Snap a picture, share and tag us:

