



## Getting Started

Before installation, check the product for any shipping damages. If you find damages, do not install and contact your dealer or ICO.

Any wall to which the vanity will be installed (with/without legs) must be of suitable construction to support the product's weight.

## Required Tools and Materials

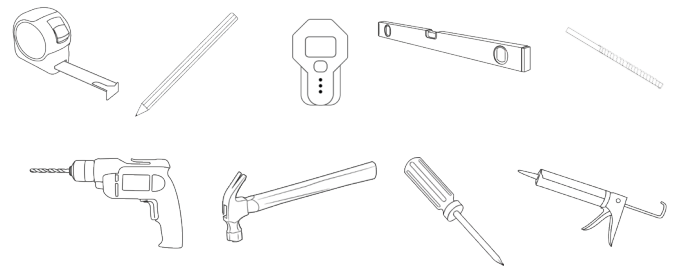

## Vanity Installation

- 1 Unpack your vanity and set it on the floor – ensure you lay out floor protection – cardboard, towel etc.
- 2 Remove the drawers from the vanity – Pull drawers all the way out, press levers underneath, then lift drawer upwards and out.

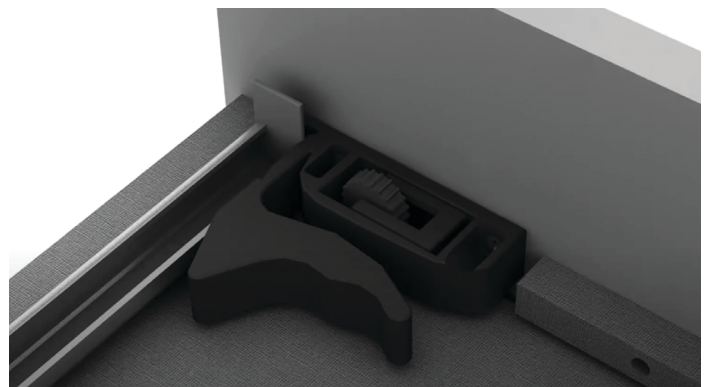

- 3 DECORATIVE LEG SET ONLY – turn vanity upside down, and use drill to attach legs to the bottom of the vanity using the provided screws.

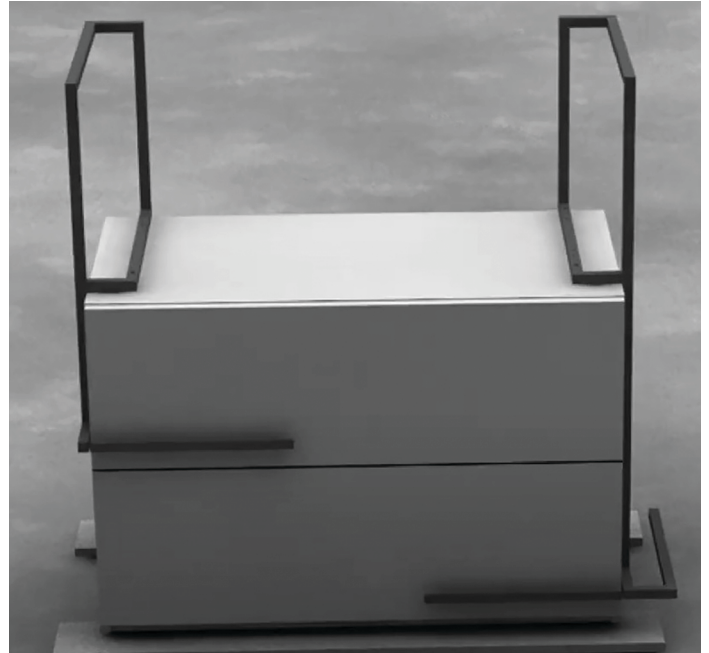

- 4 Add provided bolts to the threaded holes – only screw these in partway.

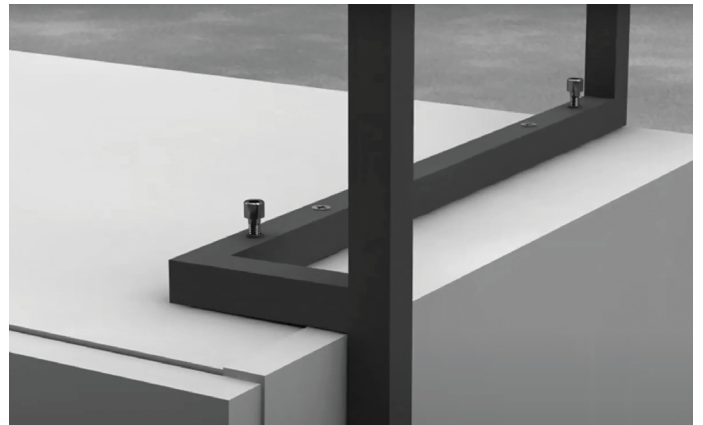

- 5 Determine the location of your vanity – we strongly recommend mounting to studs or wood backing. A horizontal stud or backing works best to ensure both brackets are firmly secured.

Mark the location of the vanity brackets on the wall – ensure enough space for legs underneath is allowed if you are using the decorative leg set.

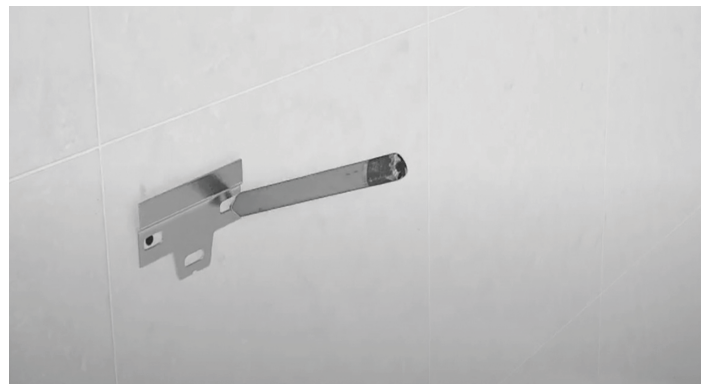

- 6 Predrill brackets and install provided drywall anchors – we suggest an 8mm - 1/8 inch bit (not necessary if mounting into studs).



- 7 Attach brackets to wall using provided screws.

Hang the vanity on the brackets.



- 8 Use the adjustment feature on the hangers to level your vanity.

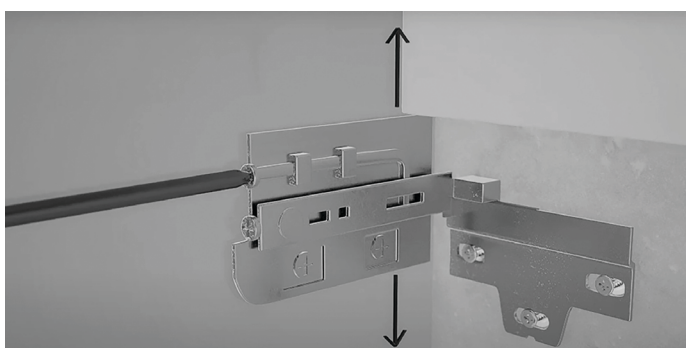

The top screw adjusts the vanity up and down, and the bottom screw adjusts the vanity front to back.

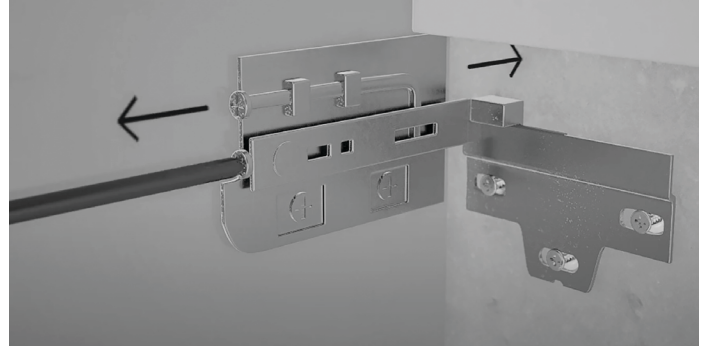

- 9 DECORATIVE LEG SET ONLY – Add the drawers back in at this point to line up the decorative legs with the drawer handles.

Loosen screws on the bottom of the vanity, then tighten the bolts until the decorative legs line up with the drawer handles. Re-tighten the screws.



- 10 Silicone the top edges of the vanity, and place sink/top – allow 24 hours for silicone to dry and cure.

- 11 Add drawers back in. You will hear a click as the drawer sits into the correct position.



Thank you for choosing Calma!

**Exhibit your Style**

Snap a picture, share and tag us:

